

NO PART OF THIS DOCUMENT MAY BE REPRODUCED WITHOUT PRIOR AGREEMENT AND WRITTEN PERMISSION OF
FORD PERFORMANCE PARTS © Ford Motor Company 2020

PRIOR TO INSTALLATION READ THESE INSTRUCTION COMPETELY
For questions, Call the FORD PERFORMANCE Techline 1-800-367-3788

Please visit <https://www.performanceparts.ford.com> for warranty information

OVERVIEW:

The use of a floor hoist is recommended for this installation. If you do not have access to one, use a hydraulic floor jack and jack stands to raise the vehicle.

!! CAUTION: JACK STANDS MUST BE USED ON A LEVEL SURFACE AND BE SECURELY SEATED. FAILURE TO DO SO MAY RESULT IN PERSONAL INJURY OR VEHICLE DAMAGE! !

Tools Required

| | |
|---------------|------------------------------|
| 3/8 ratchet | Screwdriver or small pry bar |
| 3/8 extension | 10mm socket |
| 15mm socket | WD40 or similar lubricant |

Kit Includes:

| <u>Find No.</u> | <u>Qty:</u> | <u>Description</u> |
|------------------------|--------------------|---------------------------|
| 1 | 1 | Muffler Section |
| 2 | 1 | Tailpipe section |
| 3 | 1 | 2.5" clamp |
| 4 | 1 | 2.38" clamp |

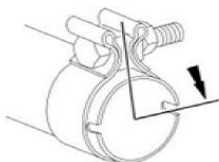

Clamp detail:

- The exhaust clamp should be installed to within a 1/16" of the edge of the expanded and notched pipe.
- The Bolt section should not be over either of the notches, Perpendicular to the notches is preferred.
- Tighten to 48 Nm (35 lb./Ft.)

High Clearance M-5200-R3

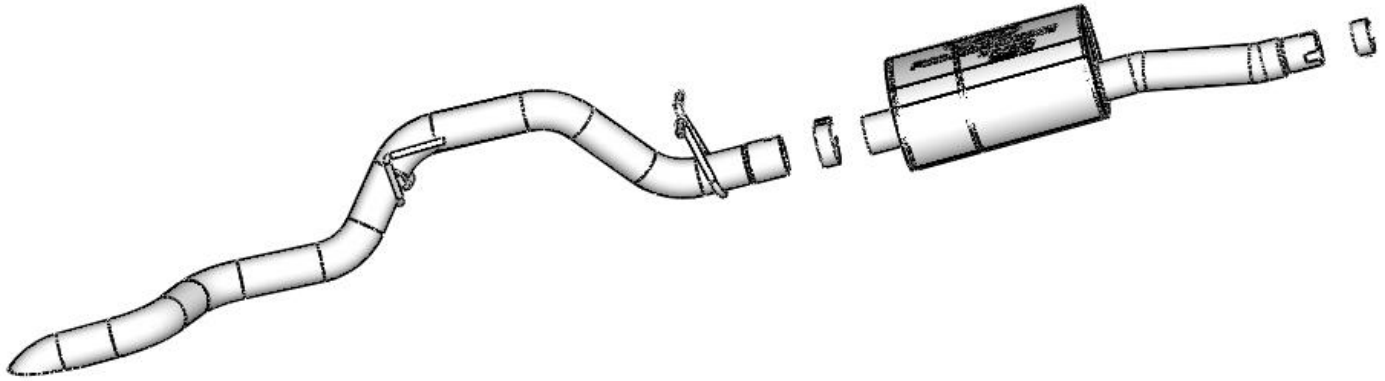

Chrome dual tips M-5200-R3C

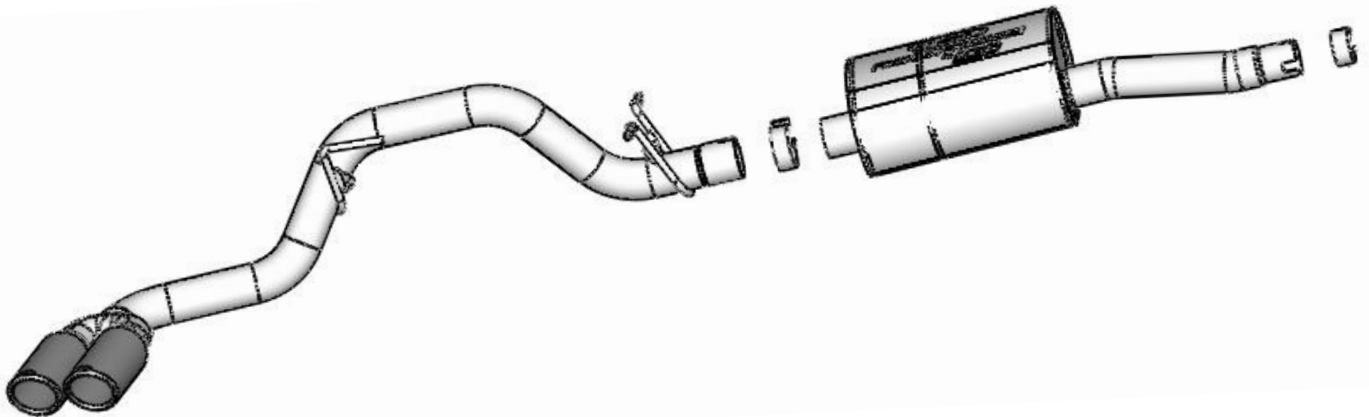

Black dual tips M-5200-R3B

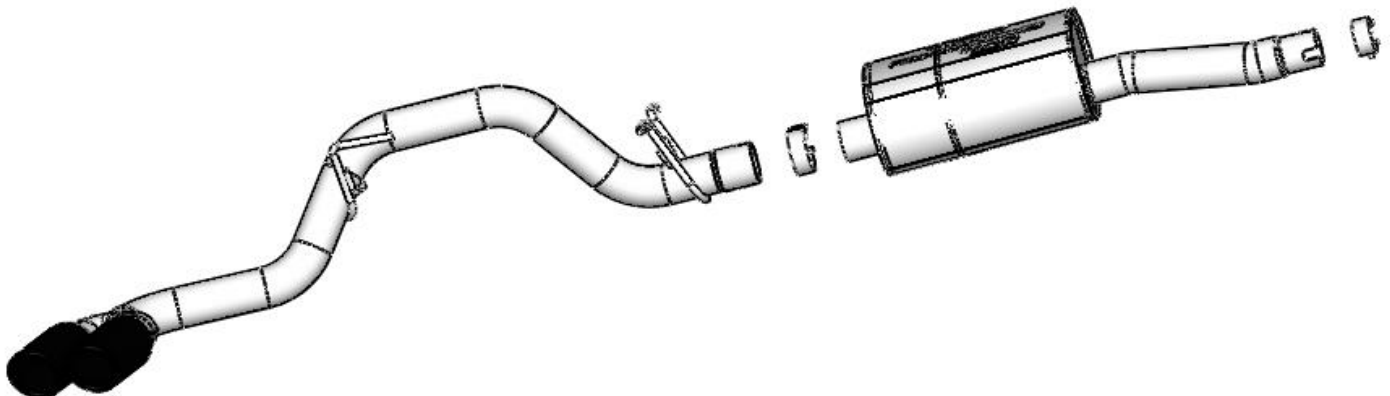

REMOVAL INSTRUCTIONS:

STEP 1: With the vehicle in NEUTRAL, position it on a hoist. Apply the emergency Brake and chock the wheels.

STEP 2: Loosen the clamp in front of the muffler.
Torque: 35 lb.ft (48 Nm)



STEP 3: Remove the 2 hangers from the isolators behind the muffler.

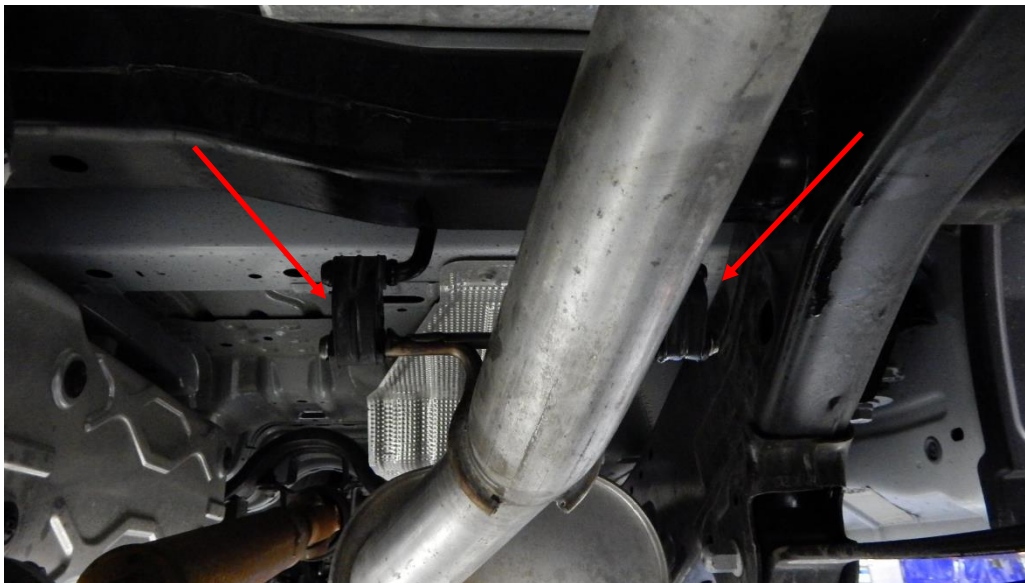

STEP 4: Slide the system rearward to pull off the front pipe, then lower and pull the system forward to remove. You will need to rotate the system to work the tailpipe over the rear axle.

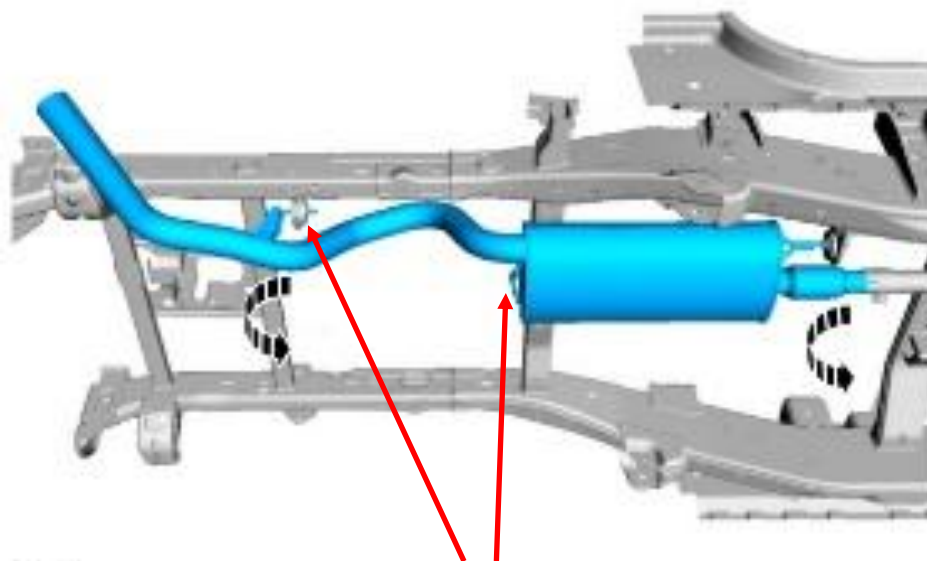

Rear hangers

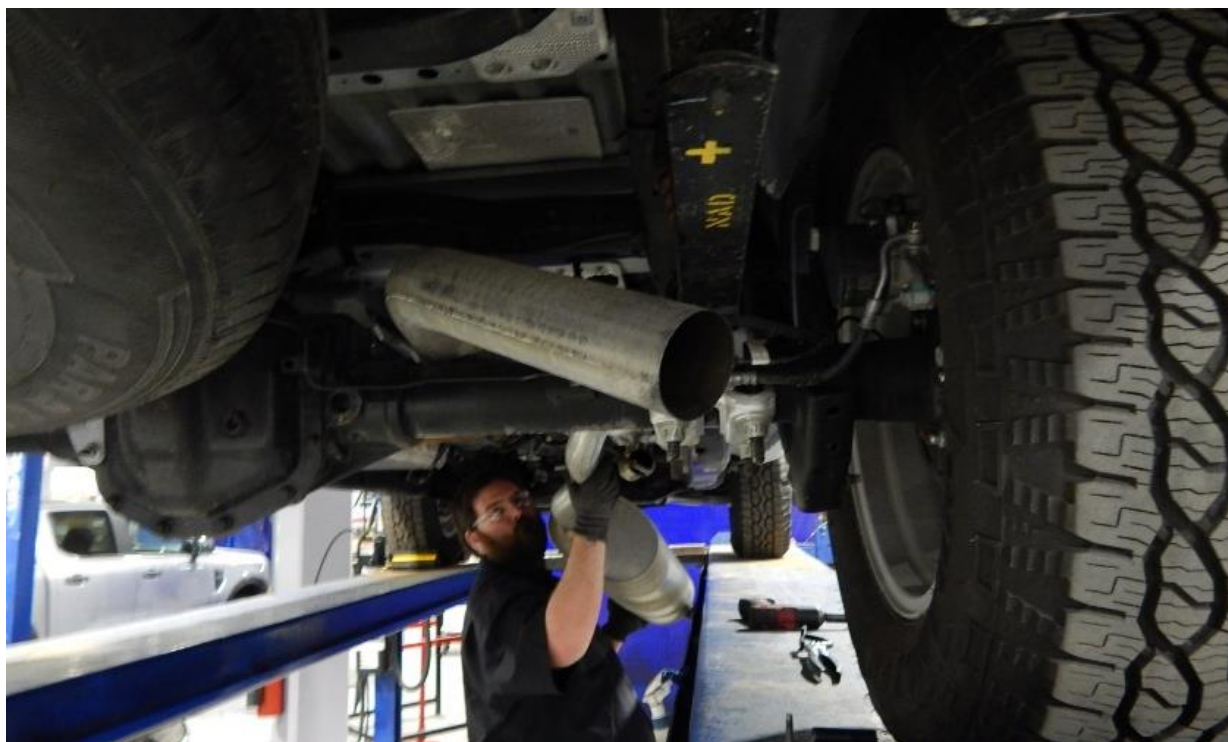

INSTALLATION INSTRUCTIONS:

STEP 1: Slide the 2.38" clamp over the expanded muffler inlet. Slide the expanded muffler inlet over the factory pipe. Line up the large notch with the locating button on the factory pipe and push on until the button bottoms out. The muffler will hang, so we recommend using a stand to hold it until the tailpipe is installed.



STEP 2: Slide the 2.5" clamp over the muffler outlet. Work the tailpipe over the rear axle. First start the rearmost hanger into the isolator, then work the expanded inlet of the tailpipe over the muffler outlet.

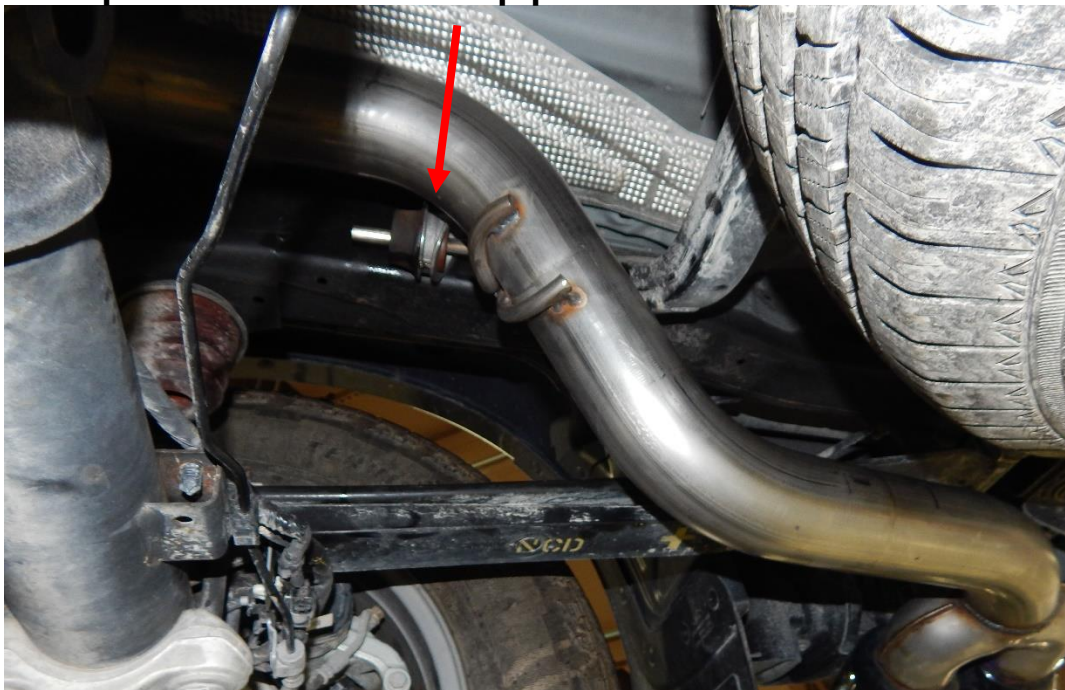

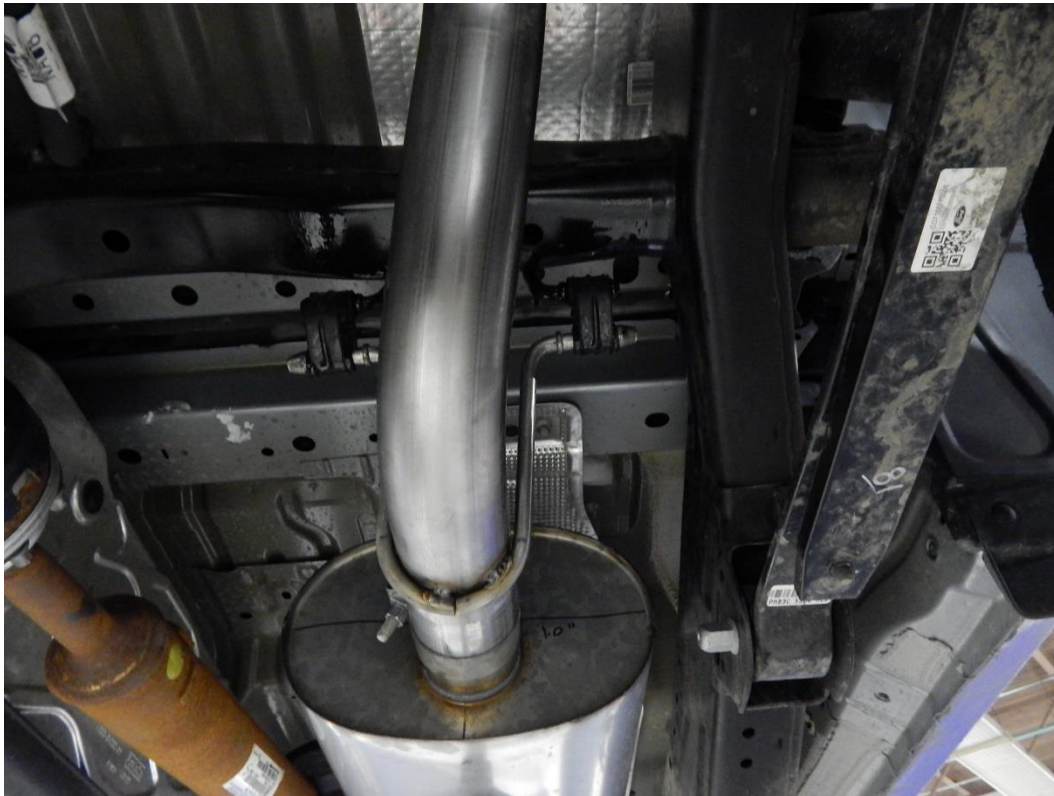

STEP 3: Slide the hangers into the isolators.

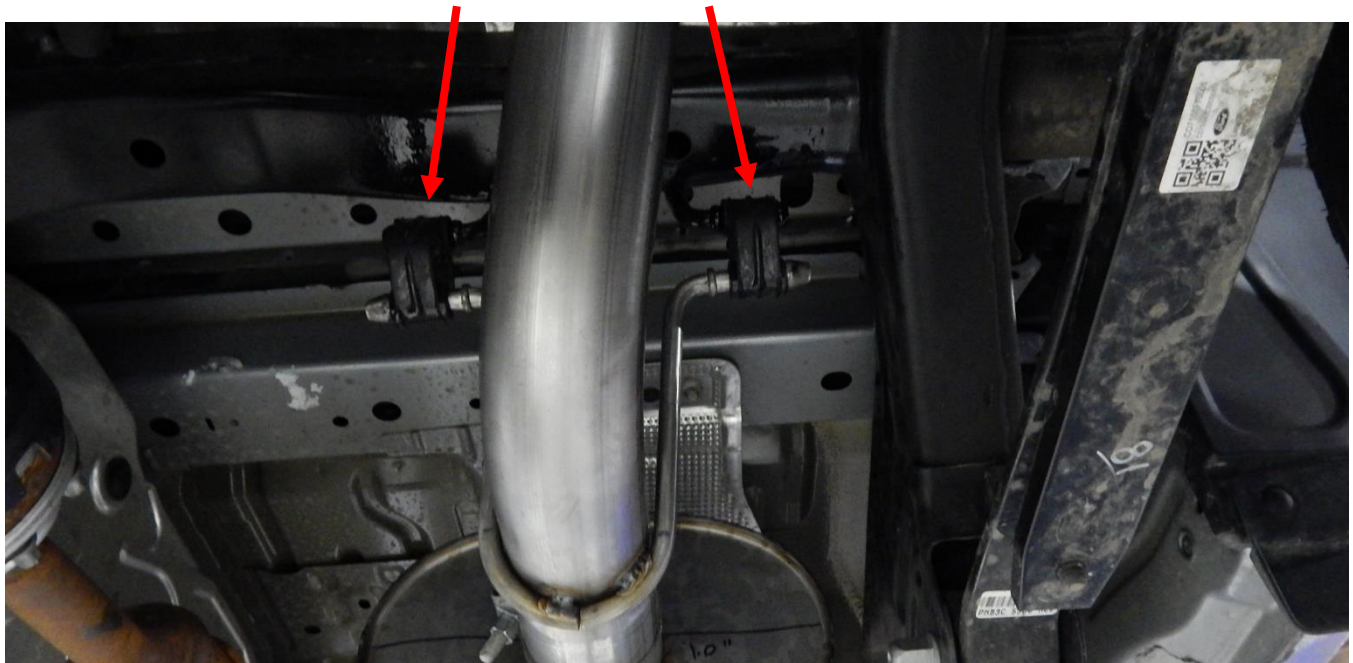

Step 4: Position the tips to have at least a 13mm gap to the fender, and 25mm inboard of the most outward feature of the truck above the tips.



Greater than
25mm

- Step 7:** Using a 15mm socket begin tightening the exhaust clamps, starting with the tailpipe first. Make sure the bolts of the clamps are not over the notches in the pipes. Also consider ground clearance when locating the clamp bolts. Once you are satisfied with your fitment torque all clamps to 48nm. (35 lb-ft).
- Step 8:** Check the exhaust for clearance to all hoses and wiring. Start the vehicle and listen for leaks. Adjust/tighten clamps as necessary.



NOTE: When you first start your vehicle after the installation of your new Ford Performance Exhaust System, there may be some smoke and fumes coming from the system. This is a protective water based coating used in the manufacturing of mandrel bent performance exhaust tubing. This is not a problem and will disappear within a very short period of time after the exhaust has reached normal operating temperatures.

For the high clearance, assembly is the same but there are no tips to align. Check the clearances to the hoses, wiring, and trailer hitch if applicable.

